



**Think Sprayer
Think ENDURASPRAY®**

Think Sprayer

Think ENDURASPRAY[®]

INTRODUCTION

The purpose of this manual is to assist you in the assembly, operation and maintenance of your 34L Push-along Sprayer. Please read through this manual completely to fully understand how to operate and maintain your equipment. This product has been manufactured to provide years of dependable service; proper operation and maintenance will ensure its dependability. Keep your manual in a safe, convenient place for future reference. Always mention the model and part number in any correspondence.

Assembly

The 34L Push-along sprayer is assembled at the factory with the exception of a few components to protect them from shipping damage. Follow the steps below to complete assembly. **For photographs showing the wiring and electrical connections of the unit go to page 7.**

Handle Assembly

1. Slide handle (Item 1, figure A) into lower frame (Item 7, figure A). Adjust handle height to a comfortable setting for the operator. Adjust handle to align the holes in handle and lower frame closest to desired setting.
2. Using the two handle adjustment knobs and bolts (Item 2, figure A) insert bolts through holes in handle and tighten with knobs.

Front Deflector Nozzle Attachment

1. Locate the bag labelled Nozzle Assembly.
2. Insert Nozzle body fitting (Item 7, figure B), through the nozzle bracket (Item 8, figure B) and hold in place with nozzle body nut (Item 9, figure B) tightened loosely by hand.
3. Insert nozzle filter (Item 9, figure B) into nozzle body. Place deflector nozzle (Item 11, figure B) into nozzle nut (Item 12, figure B). Thread nozzle nut with nozzle onto nozzle body fitting and tighten slightly.
4. Attach Nozzle bracket to tank (Item 16, figure B) with two screws and washers. Tighten securely.
5. Locate clear vinyl hose from bottom front of tank. Attach hose to nozzle body fitting attached to front of tank with hose clamp (Item 17, figure B).
6. Tighten all nuts and screws securely ensuring the nozzle is pointing directly down towards the ground.

Using the Push Along Sprayer as a Trailer

If the 34L Push Along Sprayer will be used with a garden tractor, a trailer tongue can be attached to the sprayer for towing. If the 34L Push Along Sprayer will be used as a trailer, attach the trailer tongue (Item 8, figure B) to the sprayer frame (Item 7, figure B) aligning the holes and using the pin and hair pin (Item 3, figure B).

34 Litre Push Along Sprayer 131004

Set up

Charging the Battery

1. Obtain the battery charger (Item 27, figure B) and plug the charger into an AC wall outlet and the other end into the charging port located on the sprayer.
2. Allow the charger to charge the battery until the light on the charger turns green. A green light indicates the battery is fully charged. A discharged battery may take as long as 24 hours to recharge.
3. Never allow the battery to discharge completely. Doing so will damage the battery and void warranty.

Testing

Always test the sprayer with clean water prior to spraying with a chemical mixture. This will allow the sprayer to be inspected for leaks and repaired before expensive chemicals are used.

Using the front Deflector Nozzle

Four things must be considered before spraying with the boom:

1. **How much chemical must be mixed in the tank?**
Refer to the chemical label to determine the chemical mixture.
2. **Rate of spray (to be sprayed)?**
See the tip chart below to determine the litres per hectare. The chart will also show the speed used when spraying.
3. **Speed traveled (K.P.H.) while spraying?**
Refer to the tip chart and speed chart below for KPH.
- 4) **Pressure**

Determine Litres per Hectare

Once you know how much you are going to spray then determine (from the tip chart) the spraying pressure (Psi) and the spraying speed (KPH). The pressure is preset by the pump, typically between 30 to 35 Psi, but it will vary depending on the percentage of charge left in the battery. If precise chemical metering is desired, then the battery should be fully charged and a flow rate should be measured at the nozzle. After the battery is fully charged, obtain a bucket and place under the nozzle. Turn the valve on to begin spraying water into the bucket while timing. Allow the sprayer to run for 1 minute and then turn off sprayer. Measure the amount of water within the bucket to obtain the exact LPM of the pump and nozzle.

	Litres per hectare								
Bar	L/min	6km/h	8km/h	10km/h	12km/h	14km/h	16km/h	18km/h	20km/h
1	1.39	139	104	83	69	59	52	46	42
2	1.96	196	147	118	98	84	73	65	59
3	2.4	240	180	144	120	103	90	80	72
4	2.77	277	208	166	139	119	104	92	83

Caution

Do not spray on windy days. Protective clothing must be worn in some cases. Be sure to read the chemical label carefully. After all calibrations have been completed, add water and chemical to the tank. Always follow chemical manufacturer's instructions for mixing.

Operation, Cleaning and Storage

Operation

Ensure battery is fully charged to provide optimum efficiency from the 12 volt pump. Turn the valve located in the back panel to the off position. This will ensure the nozzle does not begin to spray when the pump is activated. The pump can be operated with the switch located on the back panel or from the remote harness if connected. Remove the tank lid and fill the spray tank with clean water through the basket strainer. Slowly pour in the desired amount of chemical.

Activate the pump by turning on either switch (the pump will run with either switch in the on position. If both switches are in the on position then both will need to be turned off to disconnect power). The pump when activated will begin to run until 40 Psi is reached. The built in pressure switch will then shut off the pump.

Your sprayer is now ready.

To spray with the wand, ensure the wand nozzle is pointed in the direction meant to be sprayed and pull the lever handle. The pump will automatically activate and the wand will disperse the chemical mixture from the tank. To stop spraying with the wand release the lever handle on the spray wand and the pump will deactivate after reaching pressure.

To spray with the nozzle located on the front of the tank, ensure the wand is firmly attached to the tank or frame handle. Turn the valve located on the back panel to the ON position. The nozzle on the front of the tank will begin to spray. Immediately begin to push or pull the sprayer at the desired speed for proper chemical delivery.

To stop spraying with front nozzle, turn off the valve and the pump will deactivate after reaching pressure.

Cleaning and Storage

Most spray materials are highly corrosive. The most important aspect of long dependable service from the sprayer is a thorough cleaning immediately following each use. In addition, the residue of one type of chemical could cause an undesirable effect when a different chemical is used for a different purpose.

The most effective cleaning method is to pump several rinses of clean water through the tank, pump, hoses, boom, spray gun, etc. A neutralising agent such as a solution of Nutra-Sol, a detergent or household ammonia as recommended by the chemical manufacturer can assist in removal of a persistent chemical. When the system is thoroughly cleaned drain the tank, suction line, pump, hoses, etc.

The following steps should be followed for the maintenance and storage of your sprayer:

1. Wash and flush out sprayer after completion of each phase of your program. Flush out sprayer when changing chemicals if there is a possibility of the chemicals being incompatible. Use of a detergent is advisable if the chemical manufacturer does not make specific cleaning recommendations. Flush system completely, including nozzles. Never use metal objects to open clogged nozzles.
2. Clean sprayer thoroughly before storing at the end of the spraying season. Permanent type anti-freeze added to the final rinse will leave a rust inhibiting film in parts of the sprayer.
3. Periodically charge the battery (every 3 months) even if sprayer is not being used.

WARRANTY PARTS SERVICE

Products sold shall be warranted from defects in workmanship and material when used within the service and scope for which they were designed for a period of one year from date of purchase. Contact your distributor/dealer for replacements parts or warranty work. Please have your original sales receipt or other proof of purchase date when requesting any warranty work.

To ensure the correct parts are acquired always provide the model number of your sprayer/attachment and the part number and description obtained from the illustrated parts breakdown in this manual.

All products are sold in accordance with our terms and conditions of sales of goods. These terms and conditions can be found on our website. They are also available upon request.

34 Litre Push Along Sprayer 131004

Figure A

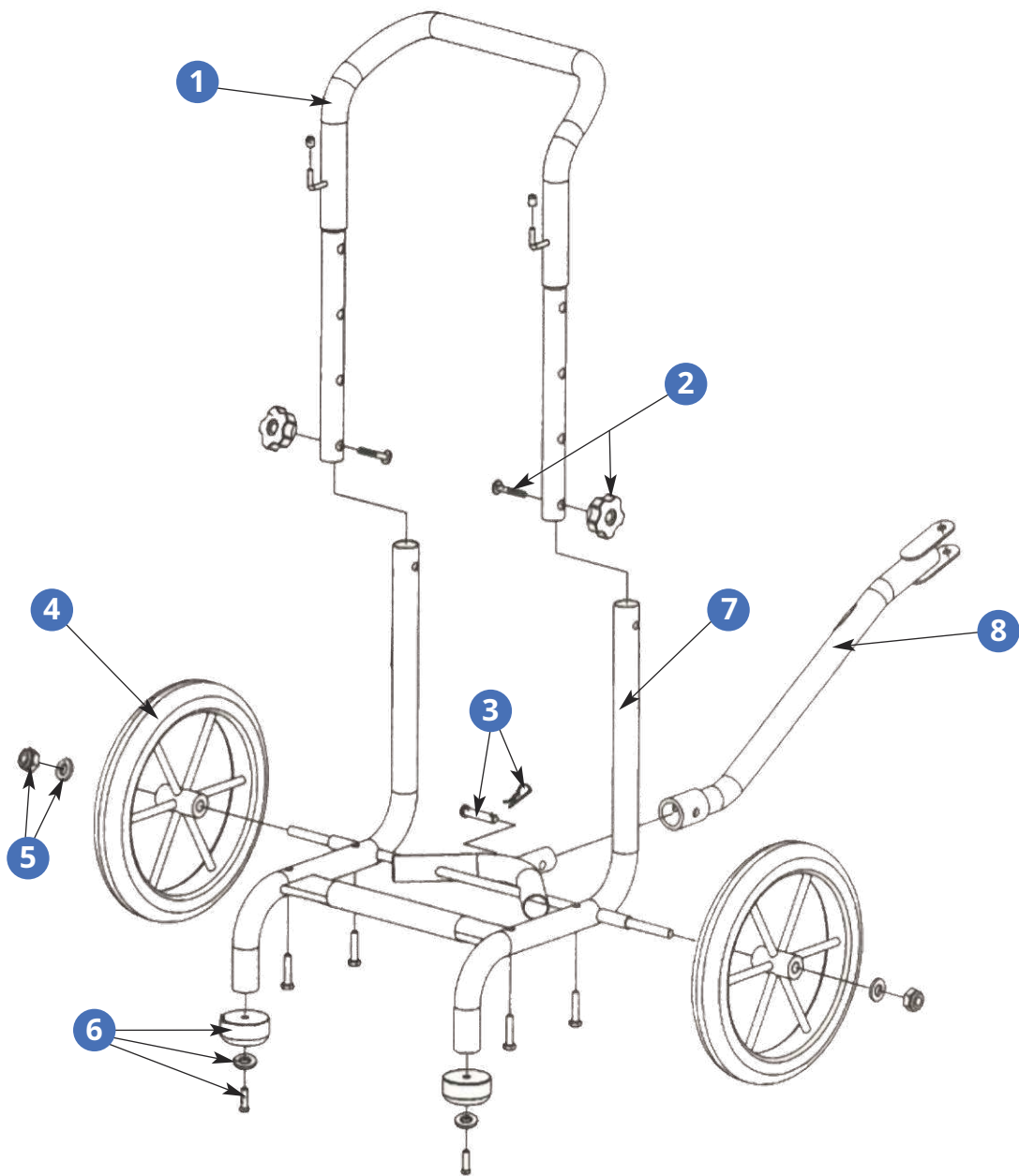

Item	Description	Quantity
1	Frame, Handle (only available as entire frame)	1
2	Handle Adjustment Knobs (pair with bolts)	1
3	Hitch Pin	1
4	Wheel and Tyre	1
5	Axle Nut and Washer (pair)	1
6	Rubber Pad (pair with bolts)	1
7	Frame, Lower (only available as entire frame)	1
8	Hitch, Tongue (only available as entire frame)	1

Tank Assembly

Figure B

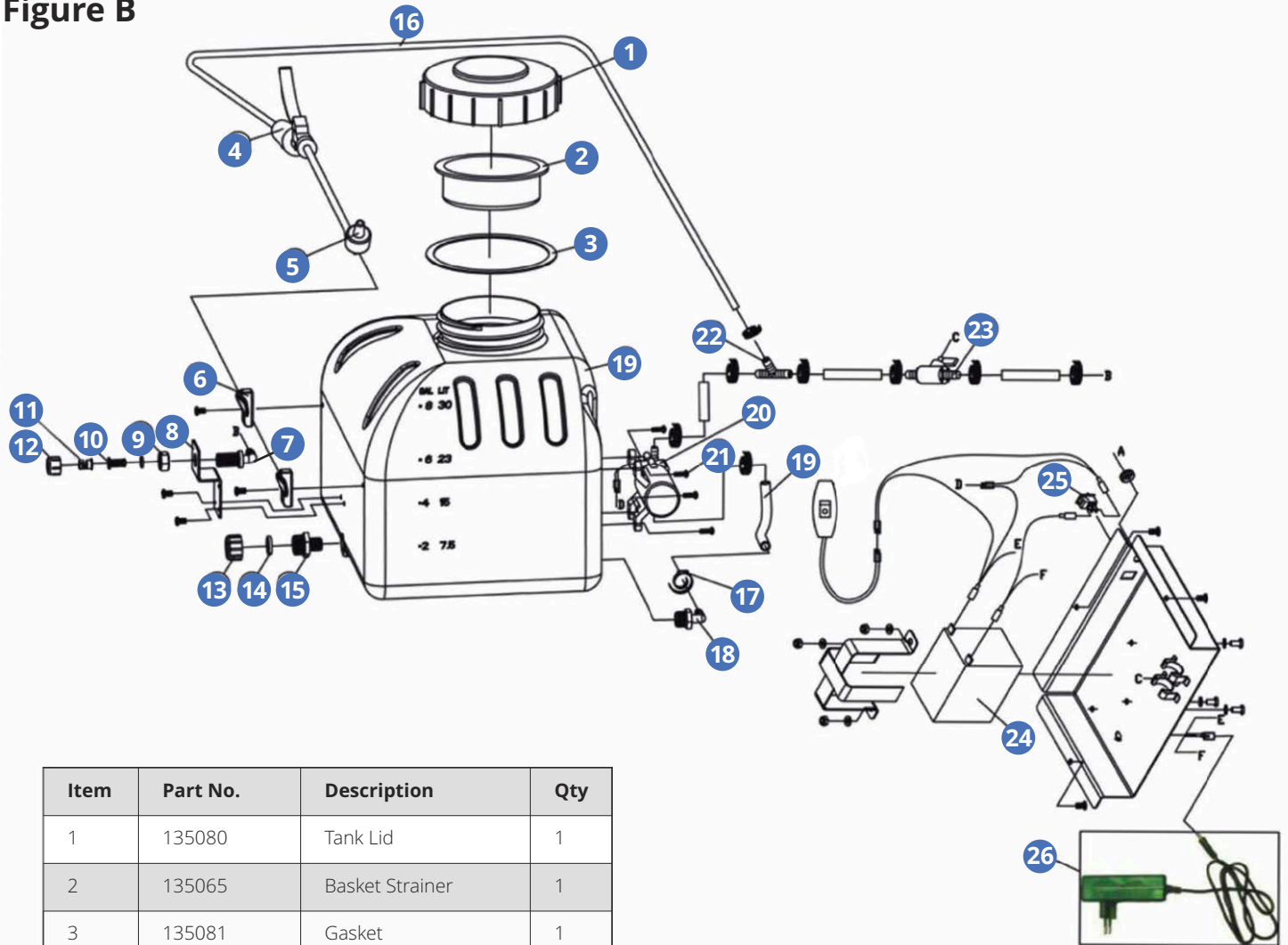

Item	Part No.	Description	Qty
1	135080	Tank Lid	1
2	135065	Basket Strainer	1
3	135081	Gasket	1
4	135005	Gun Hose Assembly	1
5	135029	Lance Nozzle	1
6	135035	Gun Clips (pair)	1
7	137088-PP	Nozzle Body	1
8	134097	Nozzle Bracket	1
9	137090-PP	Nozzle Body Nut	1
10	126026	Nozzle Strainer	1
11	123003	Nozzle	1
12	137092-PP	Nozzle Nut	1
13	135070	Cap	1
14	135072	Garden Hose Washer	1
15	137234-GHT	Adaptor, 3/4' GHT x 1/2" NPT	1
16	19141001	Hose	4-5
17	1355010	Hose Clamp	9

Item	Part No.	Description	Qty
18	137065-PP	1/2 NPT x 3/8 Hose Barb Elbow	1
19	19141001	Hose, Braided, Clear Vinyl	1
20	134012	Everflo 3.8LPM Pump	1
21	211015	Machine Screw	4
22	137068-PP	3/8" Hose Barb Tee	1
23	137002	Plastic Ball Valve – 2 x 3/8" Hose Barb	1
24	134098	12V Battery	1
25	134099	Rocker Switch	1
26	134096	Charger, 12V, UK	1

Connection Options



General view of battery/pump area



Connection if using from external power source for the pump e.g. ride on lawn mower



Connection if using the built in battery