

DATA SHEET

RHINO EFFLUENT TANK

Light weight, rust proof septic tank for multi site applications

FEATURES

- LIGHT WEIGHT
- RUST PROOF
- COATE STEEL HANDLES FOR STRENGTH
- SEALED CAPS FOR SPILL AND ODOUR REDUCTION
- MOULDED IN WARNING LABELS
- 12" ACCESS D FOR EASY CLEANING
- 5" MAX FILL HOLES
- ANGLED CORNERS FOR EASY LINKING
- WIRELSS LEVEL INDICATOR OPTION



PRODUCT CODE
DIMMENSIONS (MM)
MATERIAL
CAPACITY (L)
WEIGHT E / F (KG)
COLOURS
NO PER PALLET

TANK

EFFLUENT TANK

ET
H 0.45 L 2.8M W 2.4
UV MDPE
1700 (375GAL)
110
YELLOW, CUSTOM
-

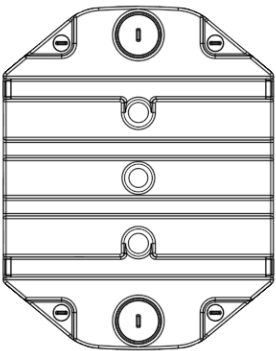

ACCESSORIES

LEVEL GAUGE

ETS
-
-
-
-
-



LINK KIT OPTION

END KIT
SIDE KIT

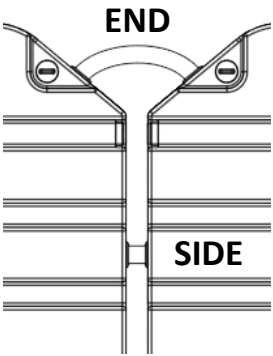

DATA SHEET

RHINO EFFLUENT TANK

Light weight, rust proof septic tank for multi site applications

STACK / STORE

LINK

BELOW CABIN

- SIDE BY SIDE
- END = NO GAP & EASY ACCESS
- SIDE = TAMPER PROOF

HORIZONTAL / VERTICAL

MIN FLOOR HEIGHT 470MM

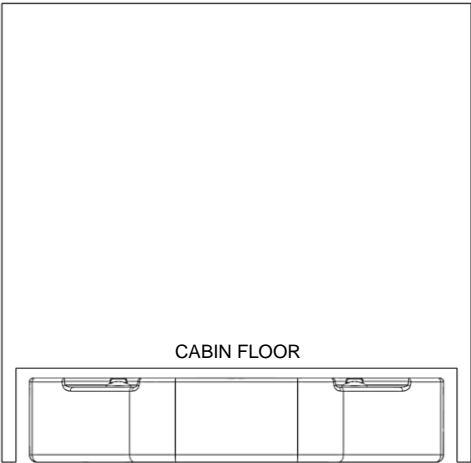
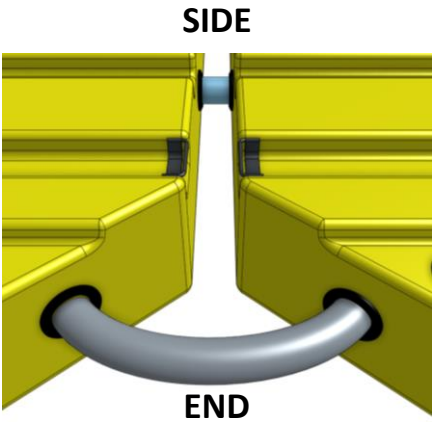
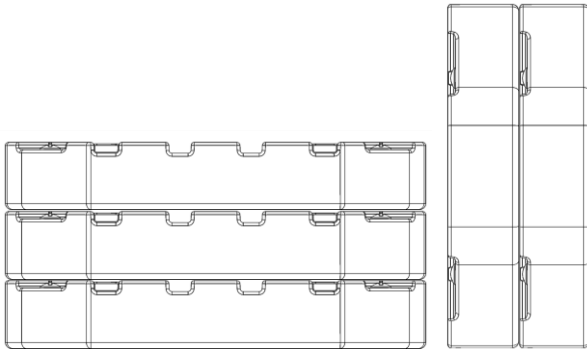

Transport and Handling:

Never move or lift a Rhino Effluent Tank that contains any sewage/ waste/ liquid.

Never drag or drop a Rhino Effluent Tank from height.

Never push a Rhino Effluent Tank with the ends of a forklift.

Lift the empty tank using all 4 handles. The weight of the empty tank when lifted needs to be evenly distributed.

If moving linked tanks make sure you remove the linking pipe and lift tanks separately.

The safest lifting methods are either crane/chain or forklift.

The tanks can be moved by hand, but we would recommend four able bodied people to move one.

Siting:

The Rhino Effluent Tank should be sited on a flat, level surface, free from debris. Propping up of the base with small items may cause damage to the underside of the tank.

The tank should **NEVER** be buried or have any other item stacked on top of it. Excessive weight over extended periods will cause the tank shape to warp.

The Rhino Effluent Tank is intended for **ABOVE GROUND USE ONLY**.

Storage / stacking:

The tanks is best stored on its side – if a side linking kit is used do not stand seal side down.

Can be store on flat side vertically or stacked on top of each other up to a recommended maximum of 3.